

SAVAGE A40 Air

Professional automatic welding helmet
with PAPR



Welding Process

- Oxy-Fuel Cutting
- Plasma Cutting
- Grinding
- Welding, GMAW (MIG/MAG)
- Welding, GTAW (TIG)
- Welding, PAW -Plasma Arc Welding
- Welding, SMAW/MMA (Stick)

Combined with ESAB PAPR the Savage A40 Air delivers uncompromising protective performance for all welding activities. The PAPR system provides user-selectable airflow control to deliver TH2-level filtration performance for fine particulates.

The welding experience is further enhanced with Savage A40's state-of-the-art ADF light filtration, offering True Colour viewing of the weld pool and full user-adjustable controls for shade, delay and sensitivity. An easy-to-access grind mode button allows fast switching between grinding and welding. The Savage A40 Air checks all the boxes for the serious and professional welder.

- External shade adjustment between DIN 9 and DIN 13 and an optical class of 1/1/1/2. Delay and sensitivity can be adjusted from the inside
- Four arc sensors for higher auto darkening response
- Wider coverage and a larger viewing area of 100 x 50 mm (3.93 x 1.96 in.) that offers a wide field of vision and increased spatial awareness
- Sensitivity control is an adaptable feature useful when welding low amp TIG for better reaction to darker arc light
- Delay control enabling the welder to set how long the lens stays dark after the welding arc stops. Short delay helps get the job done faster during tack welding, whilst longer delay is useful for high amperage welding
- Externally activated Grind Button. Shade 4 Grind Mode
- True Colour allowing for a brighter view and enhanced colour definition
- Respiratory option with ESAB PAPR

Visit esab.com for more information.



SAVAGE A40 Air

Specifications

Viewing Area	100 x 50 mm (3.93 x 1.96 in.)
Lens Shade	9-13 Automatic
Power Supply	Solar cell, Replaceable battery. (1*CR2450 lithium). Alerts when low battery.
Sensors	4
Switch Time, from Dark to Light	0.1-0.9 s
Switch Time, at 23 C	0.07 ms
Classification	1/1/1/2
Standards	CE EN379, EN175, EN12941, ANSI Z87.1 , CSA Z94.3, & AS/NZS 1338.1
Weight	700 g (1.5 lbs.)

Ordering Information

Savage A40 Air, Replaceable Battery, Black	0700500400
PAPR with Standard Hose 850 mm (33.5 in)	0700002300
PAPR with Long Hose 1000 mm (39.4 in)	0700002301

For more information on PAPR unit please see separate fact sheet or manual.

Wear and Spare Parts

1	Head Gear with Air Duct	0700500404
2	Sweat Band	0700000414
3	Face Seal	0700500405
4	Front Cover Lens	0700000010
5	Inside Cover Lens	0700000482
6	ADF Cradle	0700000418
7	Lens Retainer with Screws	0700000419
	2 x CR2450 Lithium Battery	0700000807
	Magnifying Lens +1.0 Diopter	0700000084
	Magnifying Lens +1.5 Diopter	0700000085
	Magnifying Lens +2.0 Diopter	0700000086
	Magnifying Lens +2.5 Diopter	0700000087
	Leather Chest Protection	0700000062
	Head/Neck Protection	0700000063

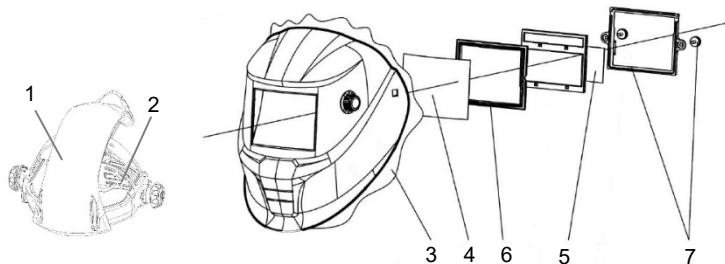

ESAB / esab.com

