



3M™ Speedglas™ Heavy Duty Welding Helmet G5-01

To optimize the effective lifetime of your welding equipment and avoid the additional cost of replacement, regular maintenance is important. Replace all damaged parts immediately to help ensure intended degree of protection. Below is a helpful overview; always read and follow User Instructions.

Before use

- Helmet and headband.** Inspect for cracks or any damaged parts. Replace if needed.
- Protection plates.** To help provide the best possible vision, they should be clean and without scratches.
- Face seal.** If the face seal is damaged, there is a risk that contaminated air will get inside the helmet. Verify it's in place and free from splits and tears.
- Welding filter.** Ensure that the low battery indicator is not flashing and check that the sensors are clean and uncovered.
- Breathing tube.** Confirm that the tube is undamaged and not leaking any air. To extend the life of the breathing tube, use a tube cover or a heavy-duty breathing tube.

After use

- Clean the helmet.** Wipe with a moist tissue or cloth, both inside and outside the helmet. If you suspect that the inside of the breathing tube is dirty, it must be changed. DO NOT rinse, immerse in water, or clean with solvents.
- Face seal and sweatband.** Remove for additional cleaning as needed and replace if they have splits or tears or whenever they become unhygienic.
- Protection plates and visor plate.** Clean with a soft cloth and replace if any pits or scratches occur.
- Breathing tube.** Replace if damaged, deformed or leaking any air.
- Storage.** Store the helmet in a dry, clean area away from direct sunlight, high temperatures and solvents.

Spare parts and consumables

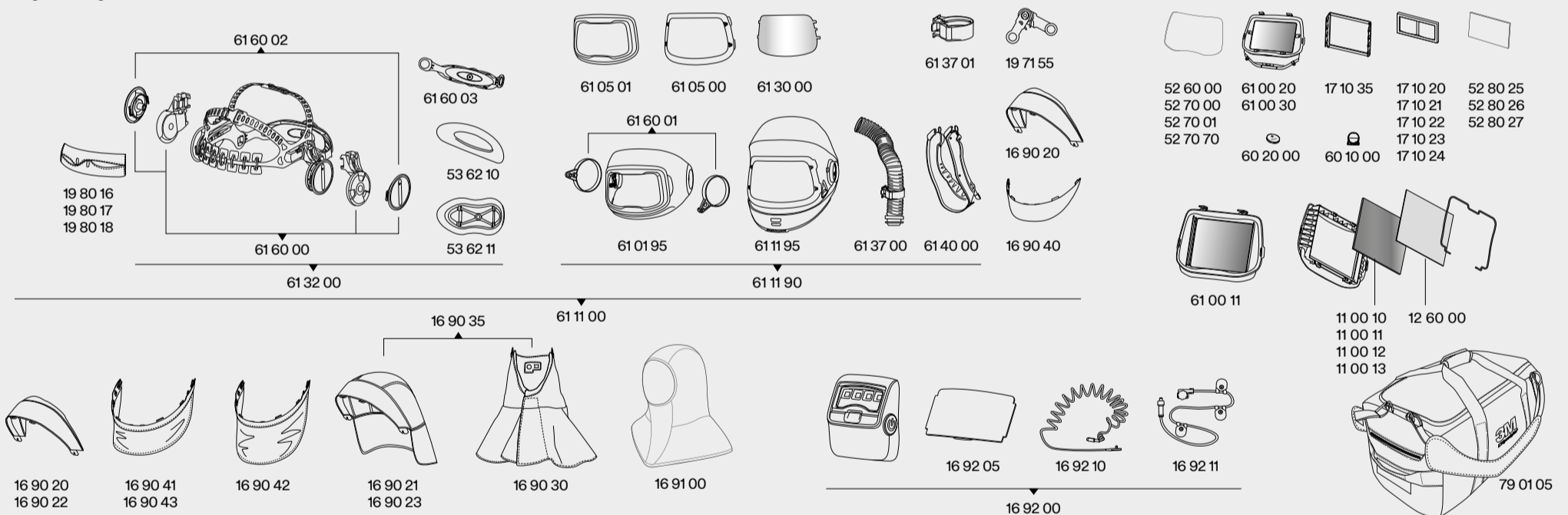

Part No	Description	Part No	Description	Part No	Description
16 90 20	Head protection in fabric	17 10 21	Magnifying lens 1.5X	61 05 00	Inner visor, including visor frame
16 90 21	Head protection High Vis	17 10 22	Magnifying lens 2.0X	61 05 01	Outer visor, including front cover
16 90 22	Head protection in leather	17 10 23	Magnifying lens 2.5X	61 11 90	Welding helmet G5-01, without welding filter, without neck or head protection
16 90 23	Head protection in fabric (large)	17 10 24	Magnifying lens 3.0X	61 11 95	Inner shield with airduct and airflow controls (including visor frame)
16 90 24	Scrape guard (not shown)	17 10 35	Magnifying lens holder	61 30 00	Visor plate, anti-fog and hardcoated, pkg. of 5
16 90 30	Shroud	19 71 55	Hinge mechanism, 1 pair	61 32 00	Headband with assembly parts
16 90 35	Extended cover kit (shroud and large head cover in fabric)	19 80 16	Sweatband (towelling), pkg of 3	61 37 00	Airduct breathing tube (short) incl. holder
16 90 41	Neck protection in fabric (small)	19 80 17	Sweatband (fleecy cotton), pkg of 3	61 37 01	Holder for breathing tube
16 90 42	Neck protection in fabric (large)	19 80 18	Sweatband (leather)	61 40 00	Face seal
16 90 43	Neck protection in leather	52 60 00	Outer protection plate (standard), pkg of 10	61 60 00	Pivot and sliding mechanism, including pivot knobs
16 92 05	Task light, incl mounting parts and cables	52 70 00	Outer protection plate (scratch), pkg of 10	61 60 01	Pivot rings for outer shield
16 92 00	Protection plate for task light, pkg. of 5	52 70 01	Outer protection plate (scratch +), pkg of 10	61 60 02	Pivot knobs
16 92 10	Long power cable for task light	52 70 70	Outer protection plate (heat), pkg of 10	61 60 03	Headband back part
16 92 11	Short power cable for task light	52 80 25	Inner cover plate, pkg of 5	79 20 00	Consumable starter kit G5-01, including sweatband, face seal, visor plate, inner and outer cover plates.
16 92 23	Pouch with Adflo battery, for task light when using supplied air regulator (not shown)	52 80 26	Inner cover plate, +1 shade, pkg of 5	79 01 05	Carry Bag
11 00 10	Passive welding filter lens shade 10 (90x110)	52 80 27	Inner cover plate, +2 shade, pkg of 5	61 78 00	Helmet G5-01, without welding filter, with 3M™ Adflo™ Powered Air Respirator
11 00 11	Passive welding filter lens shade 11 (90x110)	53 62 10	Cushion part for headband G5-01	61 78 09	Helmet G5-01, without welding filter, with 3M™ Adflo™ Powered Air Respirator and consumable starter kit
11 00 12	Passive welding filter lens shade 12 (90x110)	53 62 11	Large head rest	61 11 00	Welding helmet G5-01, without welding filter
11 00 13	Passive welding filter lens shade 13 (90x110)	60 10 00	Battery holder		
12 60 00	Inner cover plate for passive filter	60 20 00	Battery CR2450		
16 90 20	Head protection in fabric (small)	61 00 11	Speedglas passive welding filter kit G5-01 (shade 11)		
16 90 40	Neck protection rigid	61 00 20	Speedglas welding filter G5-01TW		
17 10 20	Magnifying lens 1.0X	61 00 30	Speedglas welding filter G5-01VC		
		61 01 95	Outer shield		

